



CITY COMMISSION MEETING 11-29-22 Agenda Item Request Form

ITEM: Final reading of Ordinance 3118.3 amending the Zoning Map of the City to reflect a zoning designation of Residential-1 for the property located at 2936 State Avenue.

BACKGROUND INFORMATION: Same information as previously stated in annexation agenda request.

DEPARTMENT HEAD RECOMMENDATION: Conduct a final reading of the ordinance.

ORDINANCE NO. 3118.3

AN ORDINANCE ZONING A PARCEL OF PROPERTY LOCATED AT 2936 STATE AVENUE PANAMA CITY, FLORIDA, HAVING APPROXIMATELY 0.596 ACRES, RESIDENTIAL-1, R-1, PROVIDING FOR SEVERABILITY AND PROVIDING FOR AN EFFECTIVE DATE.

WHEREAS, the owners of the parcel of property in the City have requested that the parcel as hereinafter described be zoned Residential-1, R-1; and

WHEREAS, following a public hearing of this ordinance pursuant to the statutes provided and the presentation of competent and substantial evidence and a finding that the requested zoning is consistent with the Comprehensive Plan of the City and serves a public purpose, and that enactment of this ordinance would be proper;

NOW, THEREFORE, BE IT ENACTED BY THE PEOPLE OF THE CITY OF PANAMA CITY, FLORIDA:

Section 1: The following described parcel of real property within the municipal limits of the City of Panama City, Florida, is zoned Residential-1, R-1, to-wit:

Commence at the Northwest Corner of Lot 4, St. Andrews Bay Development Company's Subdivision of Section 29, Township 3 South, Range 14 West, according to the map or plat thereof as recorded in Plat Book 6, Page 19, of the Public Records of Bay County, Florida; thence North 85°50'23" East along the North line of said Lot 4 and the center line of Baldwin Road for 50 feet to the East right of way line of State Avenue; thence South 3°29'37" East along the East right of way line of said State Avenue for 695.24 feet to the Point of Beginning; thence continue South 3°29'37" East along said right of way line for 130 feet; thence North 86°30'23" East at a right angle for 200 feet; thence North 3°29'37" West, parallel with said right of way line, for 130 feet; thence South 86°30'23" West for 200 feet to the Point of Beginning.

Parcel Account Number: 12989-109-000

Address: 2936 State Avenue, Panama City, Florida 32405

For Map of Property See "Exhibit A"

Section 2: The Official Zoning Map is amended to reflect the zoning of the above referenced property.

Section 3: All ordinances or parts of ordinances in conflict herewith are hereby repealed to the extent of such conflict.

Section 4: This Ordinance shall take effect upon the effective date of the corresponding comprehensive plan map amendment, to reflect the designated zoning adopted in this Ordinance of the above referenced parcel.

PASSED, APPROVED, AND ADOPTED at the regular meeting of the Mayor and City Commission of the City of Panama City, Florida this 29th of November, 2022.

CITY OF PANAMA CITY, FLORIDA
A Municipal Corporation,

By _____
Greg Brudnicki, Mayor

ATTEST:

Jan Smith, City Clerk-Treasurer

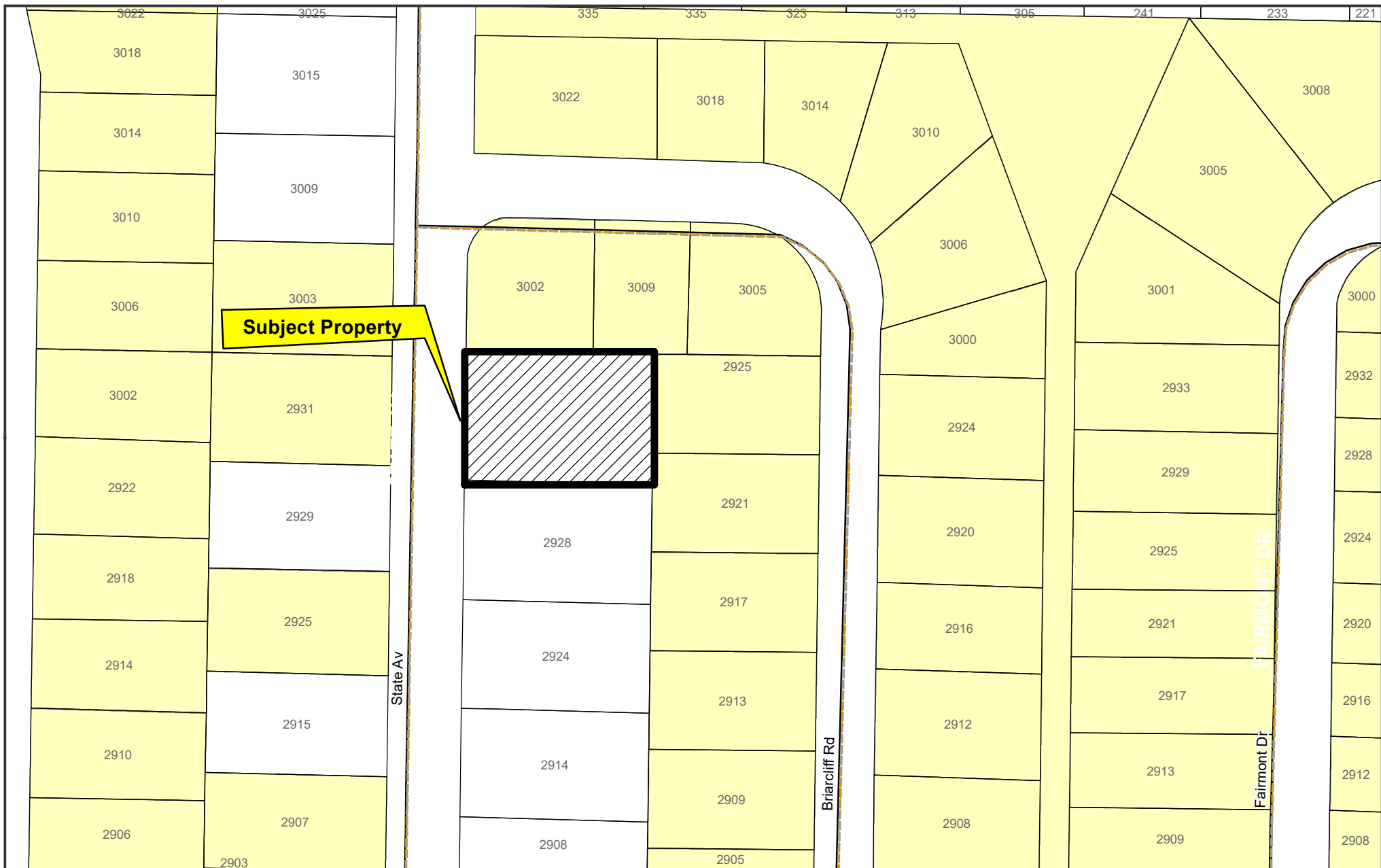

Exhibit A

Zoning Map City of Panama City

Legend

Zoning Districts		Legend	
Downtown District	Mixed Use - 1	Recreation	Urban Residential 3
General Commercial - 1	Mixed Use - 2	Residential - 1	Shoreline
General Commercial - 2	Mixed Use - 3	Residential - 2	Water
Heavy Industry	Planned Unit Development (PUD)	Silviculture	NOT ZONED
Light Industry	Preservation	Urban Residential 1	Parcels
	Public/Institutional	Urban Residential 2	



1 inch = 132 feet